

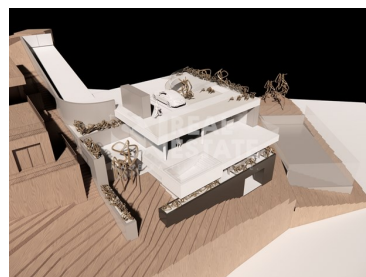

Estreito da Calheta - Land



3	1042	1042		185 000 €
Bedrooms	Area (m²)	Land Area (m²)	Garage	(EUR €)

Land with project close to the sea

The opportunity to acquire this unique land with an architectural project in the charming parish of Estreito da Calheta is now. With a total area of 1042 square meters, this property offers the perfect base to create the home of your dreams. With a project underway, this 3 bedroom project is ready to be transformed into a personalized refuge for you and your family or for investment.

In the surroundings of this plot, you will find a variety of local amenities within walking distance.

This vibrant location combines local shopping convenience with memorable culinary experiences. Don't miss the opportunity to create your dream home on this stunning plot of land in Calheta. Schedule a visit today.



Lucas

+351 925 620 160 ²

clucas@snimobiliaria.com

T (+351) 291 220 022 ¹ · T (+351) 964 122 252 ² · E info@snimobiliaria.com

Rua da Queimada de Cima nº28 1ºG, 9000-065 Funchal
AMI 13770

¹ (Call to national fixed network) | ² (Call to national mobile network)



Property Features

- Air conditioning
- Air Conditioning: sim
- Views: Sea View, Vista Serra
- Roof terrace
- Terrace
- Churrasqueira
- Thermal insulation: sim
- Home Automation
- Orientação: Sul, Este, Oeste
- Central location
- Garage
- Nº Floors: 2



Lucas

+351 925 620 160 ²

clucas@snimobiliaria.com

T (+351) 291 220 022 ¹ · T (+351) 964 122 252 ² · E info@snimobiliaria.com

**Rua da Queimada de Cima nº28 1ºG, 9000-065 Funchal
AMI 13770**

¹ (Call to national fixed network) | ² (Call to national mobile network)